

Nu Victorian Urn Large Slim Face Fix



Features

- **Classic door knocker design**
Create an elegant and stylish front door
- **Patented face fixing plate works with all major door materials**
Easy installation; no need to use fixing bolts or to drill through the door (unless using optional viewer)
- **Available with or without door viewer aperture**
Options to neatly conceal the door viewer
- **Wide range of viewers and extensions available**
Cater for all major door depths



Hardex
Chrome



Hardex
Satin



White



Hardex
Bronze

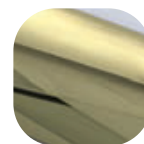

Hardex
Gold



Black

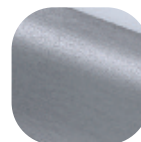

Hardex
Graphite

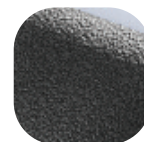

Antique
Black



Silver

Nu Victorian Urn Large Slim Face Fix

Ordering Details

Product	Part No.	
Nu Victorian Urn Large Slim Face Fix		
Finish	With Spyhole	Without Spyhole
Hardex Chrome	4A354	4A304
Hardex Satin	4A355	4A305
Hardex Bronze	4A356	4A306
Hardex Gold	4A358	4A308
Hardex Graphite	4A361	4A311
Antique Black	4A359	4A309
White	4A350	4A300
Black	4A351	4A301
Silver	4A352	4A302

Technical Information

Corrosion resistance

Meets the requirements of BS EN 1670:2007 Grade 5 (480 hours)

Material Specification

Knocker:	High quality Zinc
Coatings:	Hardex Chrome, Hardex Satin, Hardex Bronze, Hardex Gold, Hardex Graphite, Antique Black, White, Black and Silver.

Maintenance

For continued protection of the quality finish and appearance, Fab&Fix advise routine cleaning of all our external hardware. Moving parts should also be lightly lubricated at least twice a year. This procedure is particularly essential if products are used within a 25-mile radius of coastal areas or close proximity to building sites or large industrial areas, where more frequent cleaning may be required to prevent the accumulation of corrosive contaminants.

Packaging

Urn Knocker

Individually boxed with fixings and care instructions.
20 knockers in an outer box.

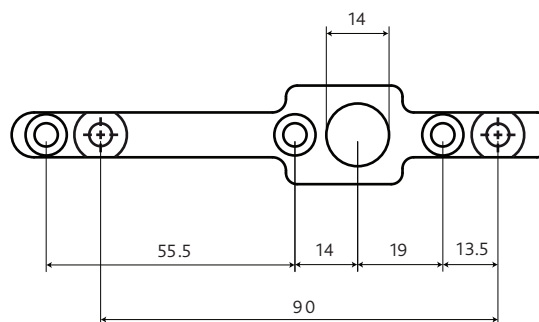
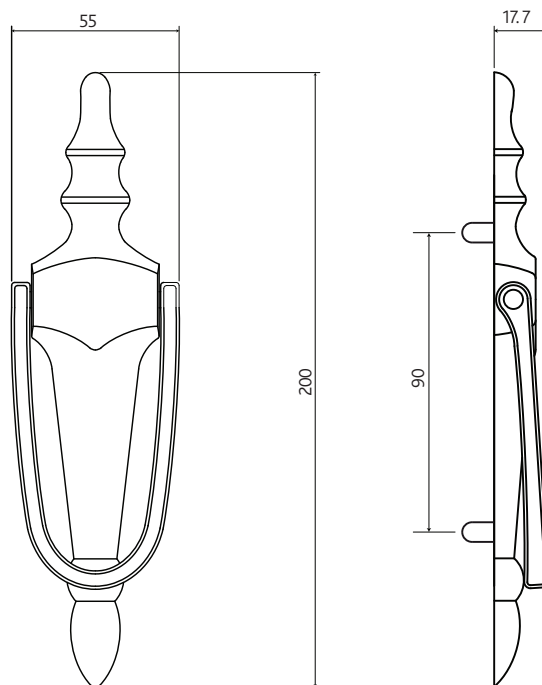

All dimensions are in mm and are nominal.

Fab&Fix reserves the right to change specification without notice.
It is the responsibility of the door manufacturer to ensure that the finished product meets any required safety and performance specification.